



8" (200 mm)

Water Filled Submersible Motor

50 Hz.

www.virasubmersible.com

Features

- 8" Water filled submersible motor.
- Easily rewindable (wet wound) induction motor with PE insulated windings.
- Corrosion resistant stainless steel stator jacket and shaft.
- Mechanical shaft seal (Carbon/Ceramic) provided.
- Water lubricated radial and axial thrust bearings.
- Counter thrust bearing.
- Motors are pre-filled with clean water + Glycol mixture.
- High efficiency electrical design (lower operating cost).
- Tropicalized design (lower winding temperature).
- 8" NEMA coupling flange.
- Pressure compensation diaphragm.

Specifications

- Ratings: Three phase - 30 to 110 kW, 50 Hz
37 to 110 kW, 60 Hz
- Supply voltages (Tolerance +10% / -15%):
50 Hz, 3 phase, 380 V, 400 V, 415 V
60 Hz, 3 phase, 230 V, 380 V, 460 V
- Degree of protection: IP 68
- Continuous duty
- Ambient temperature: 45°C
- Rotation: Three phase - CCW and CW
- Maximum nos. of starts/hour:
30 to 55 kW - 25
66 to 110 kW - 20
- Water pH: 6,5 - 8
- Minimum cooling flow along the motor:
30 to 37 kW - 30 cm/sec
45 to 110 kW - 45 cm/sec
- Motor protection: Select thermal overload protection with trip time < 10 sec. at 5 x I_n
- Maximum submerged depth: 200 metres.

Special features on request

- Mechanical shaft seal Sic/Sic.
- Built-in PT 100 temperature sensor.
- Special voltages.
- Double cable for Star - Delta operation.

Cable data

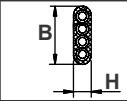
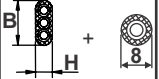
kW	Type of start	Cable x Leads x Size (mm ²)	Length [m]	H x B [mm]	
30 - 93	DOL	1 x 4 x 16	5	14 x 37,6	
110	DOL	1 x 3 x 35 + 1 x 1 x 16	5	15,3 x 35	

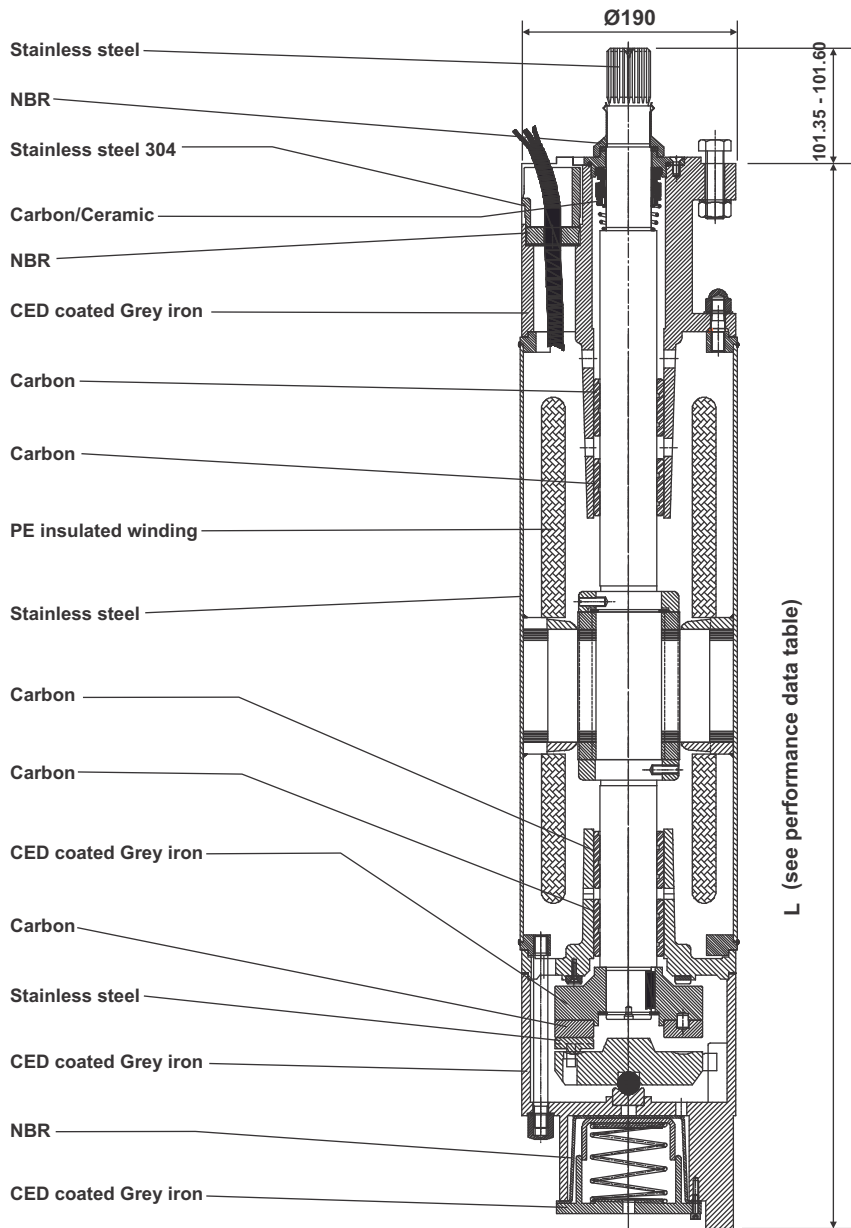
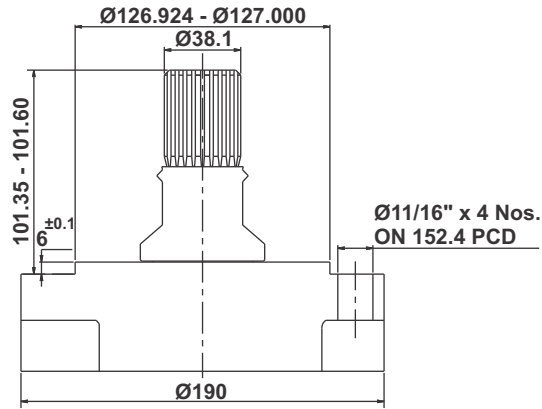

Shaft

Spline shaft: 23 teeth, 16/32 pitch, module
 1.5875, 30° pressure angle, coupling tolerance
 5 as per ANSI B.92.1, confirming with NEMA 8".



Performance data

50 Hz

Motor type	Pn		Ka [N]	Un [V]	In	Ist/In	n [min ⁻¹]	η [%]			COS φ			Tn [Nm]	L [mm]	Gross weight [kg]	Gross volume [m ³]
	kW	HP						50%	75%	100%	50%	75%	100%				
VCW82404732	30	40	45000	380	62,8	4,51	2890	79,9	83,3	84,2	0,72	0,83	0,89	99,19	1041	166,2	0,1905
				400	59,9	4,61	2900	81,1	84,1	85,0	0,71	0,84	0,89	98,84			
				415	57,8	4,66	2900	80,7	83,9	84,9	0,69	0,83	0,88	98,84			
VCW82504732	37	50	45000	380	78,0	4,70	2890	80,1	83,1	84,1	0,74	0,84	0,88	122,30	1131	182,2	0,2017
				400	75,0	4,80	2900	81,3	84,1	85,0	0,72	0,83	0,86	121,90			
				415	74,0	4,85	2900	80,7	83,5	84,4	0,70	0,80	0,84	121,90			
VCW82604732	45	60	45000	380	92,5	4,70	2890	80,3	83,3	85,2	0,73	0,87	0,88	148,80	1231	200,2	0,2167
				400	89,8	4,80	2900	81,5	84,1	85,9	0,72	0,81	0,86	148,30			
				415	88,8	4,90	2900	81,3	83,9	85,8	0,70	0,80	0,84	148,30			
VCW82754732	55	75	45000	380	113,8	4,90	2890	80,5	84,1	85,7	0,74	0,84	0,88	181,84	1281	209,2	0,2241
				400	109,5	5,00	2910	81,9	85,1	86,4	0,72	0,82	0,86	180,60			
				415	108,8	5,10	2910	81,5	84,7	86,2	0,69	0,80	0,84	180,60			
VCW82904732	66	90	45000	380	135,5	4,90	2890	80,7	85,3	86,4	0,74	0,85	0,89	218,20	1369	213,6	0,2391
				400	131,0	5,00	2910	81,9	85,9	86,9	0,72	0,83	0,86	216,70			
				415	128,5	5,05	2910	81,3	85,3	86,6	0,69	0,81	0,84	216,70			
VCW83104732	75	100	45000	380	151,0	4,91	2890	80,9	84,7	86,2	0,74	0,85	0,89	247,96	1419	243,2	0,2465
				400	147,0	5,01	2910	81,9	85,5	87,0	0,72	0,83	0,87	246,26			
				415	145,5	5,11	2910	81,7	85,3	86,6	0,70	0,79	0,84	246,26			
VCW83124732	93	125	45000	380	186,8	4,91	2900	80,5	84,5	86,5	0,75	0,84	0,88	306,40	1559	283,2	0,2652
				400	181,0	5,01	2910	81,5	86,4	87,8	0,71	0,81	0,86	305,36			
				415	180,5	5,06	2920	81,7	85,5	87,0	0,70	0,79	0,84	304,31			
VCW83154732	110	150	45000	380	231,0	4,92	2890	79,0	83,3	85,0	0,72	0,81	0,85	363,68	1689	359,2	0,2839
				400	224,0	5,02	2900	79,5	84,1	85,5	0,71	0,79	0,83	362,42			
				415	220,0	5,08	2900	80,0	84,7	86,0	0,69	0,77	0,81	362,42			

Pn: Rated output
 Ka: Thrust load
 Un: Rated voltage
 In: Rated current
 Ist/In: Locked rotor current/Rated amperage
 n: Rated speed
 η: Efficiency
 cos φ: Power factor
 Tn: Rated torque
 L: Motor length



Features

- 8" Water filled stainless steel submersible motor.
- Easily rewindable (wet wound) induction motor with PE insulated windings.
- Completely stainless steel AISI 304 construction.
- Mechanical shaft seal (Carbon/Ceramic) provided.
- Water lubricated radial and axial thrust bearings.
- Counter thrust bearing.
- Motors are pre-filled with clean water + Glycol mixture.
- Shaft extension made of stainless steel AISI 316.
- High efficiency electrical design (lower operating cost).
- Tropicalized design (lower winding temperature).
- 8" NEMA coupling flange.
- Pressure compensation diaphragm.

Specifications

- Ratings: Three phase - 30 to 110 kW, 50 Hz
37 to 110 kW, 60 Hz
- Supply voltages (Tolerance +10% / -15%):
50 Hz, 3 phase, 380 V, 400 V, 415 V
60 Hz, 3 phase, 230 V, 380 V, 460 V
- Degree of protection: IP 68
- Continuous duty
- Ambient temperature: 45°C
- Rotation: Three phase - CCW and CW
- Maximum nos. of starts/hour:
30 to 55 kW - 25
66 to 110 kW - 20
- Water pH: 6,5 - 8
- Minimum cooling flow along the motor:
30 to 37 kW - 30 cm/sec
45 to 110 kW - 45 cm/sec
- Motor protection: Select thermal overload protection with trip time < 10 sec. at 5 x I_n
- Maximum submerged depth: 200 metres.

Special features on request

- Mechanical shaft seal Sic/Sic.
- Built-in PT 100 temperature sensor.
- Special voltages.
- Double cable for Star - Delta operation.

Cable data

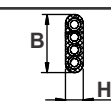
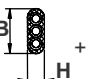
kW	Type of start	Cable x Leads x Size (mm ²)	Length [m]	H x B [mm]	
30 - 93	DOL	1 x 4 x 16	5	14 x 37,6	
110	DOL	1 x 3 x 35 + 1 x 1 x 16	5	15,3 x 35	

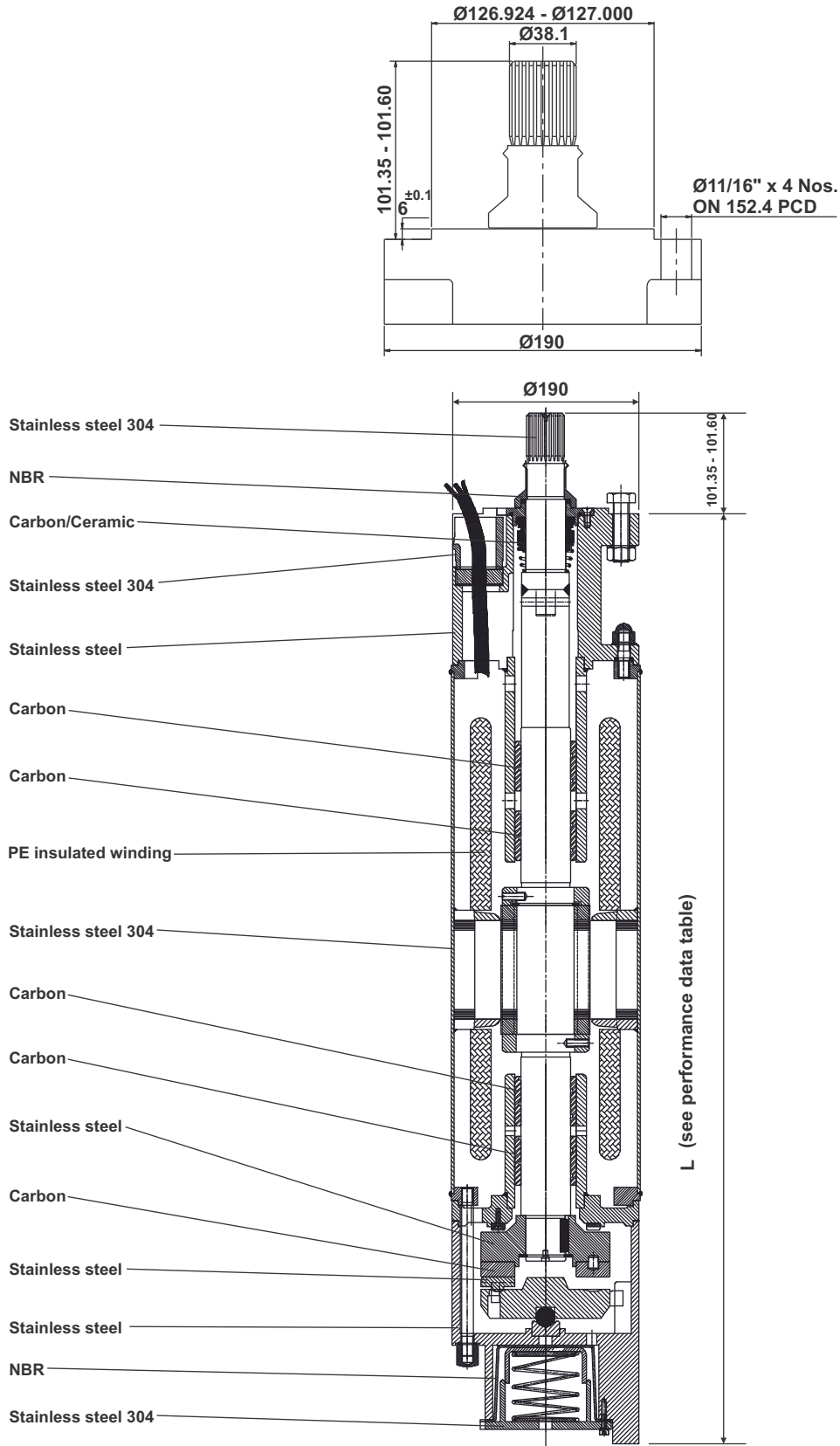

Shaft

Spline shaft: 23 teeth, 16/32 pitch, module 1.5875, 30° pressure angle, coupling tolerance 5 as per ANSI B.92.1, confirming with NEMA 8".



Performance data

50 Hz

Motor type	Pn		Ka [N]	Un [V]	In	Ist/In	n [min ⁻¹]	η [%]			COS φ			Tn [Nm]	L [mm]	Gross weight [kg]	Gross volume [m ³]
	kW	HP						50%	75%	100%	50%	75%	100%				
VSW82404732	30	40	45000	380	62,8	4,51	2890	79,9	83,3	84,2	0,72	0,83	0,89	99,19	1041	166,2	0,1905
				400	59,9	4,61	2900	81,1	84,1	85,0	0,71	0,84	0,89	98,84			
				415	57,8	4,66	2900	80,7	83,9	84,9	0,69	0,83	0,88	98,84			
VSW82504732	37	50	45000	380	78,0	4,70	2890	80,1	83,1	84,1	0,74	0,84	0,88	122,30	1131	182,2	0,2017
				400	75,0	4,80	2900	81,3	84,1	85,0	0,72	0,83	0,86	121,90			
				415	74,0	4,85	2900	80,7	83,5	84,4	0,70	0,80	0,84	121,90			
VSW82604732	45	60	45000	380	92,5	4,70	2890	80,3	83,3	85,2	0,73	0,87	0,88	148,80	1231	200,2	0,2167
				400	89,8	4,80	2900	81,5	84,1	85,9	0,72	0,81	0,86	148,30			
				415	88,8	4,90	2900	81,3	83,9	85,8	0,70	0,80	0,84	148,30			
VSW82754732	55	75	45000	380	113,8	4,90	2890	80,5	84,1	85,7	0,74	0,84	0,88	181,84	1281	209,2	0,2241
				400	109,5	5,00	2910	81,9	85,1	86,4	0,72	0,82	0,86	180,60			
				415	108,8	5,10	2910	81,5	84,7	86,2	0,69	0,80	0,84	180,60			
VSW82904732	66	90	45000	380	135,5	4,90	2890	80,7	85,3	86,4	0,74	0,85	0,89	218,20	1369	213,6	0,2391
				400	131,0	5,00	2910	81,9	85,9	86,9	0,72	0,83	0,86	216,70			
				415	128,5	5,05	2910	81,3	85,3	86,6	0,69	0,81	0,84	216,70			
VSW83104732	75	100	45000	380	151,0	4,91	2890	80,9	84,7	86,2	0,74	0,85	0,89	247,96	1419	243,2	0,2465
				400	147,0	5,01	2910	81,9	85,5	87,0	0,72	0,83	0,87	246,26			
				415	145,5	5,11	2910	81,7	85,3	86,6	0,70	0,79	0,84	246,26			
VSW83124732	93	125	45000	380	186,8	4,91	2900	80,5	84,5	86,5	0,75	0,84	0,88	306,40	1559	283,2	0,2652
				400	181,0	5,01	2910	81,5	86,4	87,8	0,71	0,81	0,86	305,36			
				415	180,5	5,06	2920	81,7	85,5	87,0	0,70	0,79	0,84	304,31			
VSW83154732	110	150	45000	380	231,0	4,92	2890	79,0	83,3	85,0	0,72	0,81	0,85	363,68	1689	359,2	0,2839
				400	224,0	5,02	2900	79,5	84,1	85,5	0,71	0,79	0,83	362,42			
				415	220,0	5,08	2900	80,0	84,7	86,0	0,69	0,77	0,81	362,42			

Pn: Rated output
 Ka: Thrust load
 Un: Rated voltage
 In: Rated current
 Ist/In: Locked rotor current/Rated amperage
 n: Rated speed
 η: Efficiency
 cos φ: Power factor
 Tn: Rated torque
 L: Motor length



Features

- 8" Water filled heavy duty submersible motor.
- Easily rewindable (wet wound) induction motor with PE insulated windings.
- Corrosion resistant stainless steel stator jacket and shaft.
- Mechanical shaft seal (Carbon/Ceramic) provided.
- Water lubricated heavy duty radial and axial thrust bearings.
- Counter thrust bearing.
- Motors are pre-filled with clean water + Glycol mixture.
- High efficiency electrical design (lower operating cost).
- Tropicalized design (lower winding temperature).
- 8" NEMA coupling flange.
- Pressure compensation diaphragm.

Specifications

- Ratings: Three phase - 30 to 130 kW, 50 Hz
30 to 130 kW, 60 Hz
- Supply voltages (Tolerance +10% / -15%):
50 Hz, 3 phase, 380 V, 400 V, 415 V
60 Hz, 3 phase, 230 V, 380 V, 460 V
- Degree of protection: IP 68
- Continuous duty
- Ambient temperature: 45°C
- Rotation: Three phase - CCW and CW
- Maximum nos. of starts/hour:
30 to 55 kW - 25
66 to 130 kW - 20
- Water pH: 6,5 - 8
- Minimum cooling flow along the motor:
30 to 37 kW - 30 cm/sec
45 to 130 kW - 45 cm/sec
- Motor protection: Select thermal overload protection with trip time < 10 sec. at 5 x I_n
- Maximum submerged depth: 200 metres.

Special features on request

- Mechanical shaft seal Sic/Sic.
- Built-in PT 100 temperature sensor.
- Special voltages.
- Double cable for Star - Delta operation.

Cable data

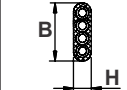
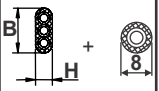
kW	Type of start	Cable x Leads x Size (mm ²)	Length [m]	H x B [mm]	
30 - 93	DOL	1 x 4 x 16	5	14 x 37,6	
110 - 130	DOL	1 x 3 x 35 + 1 x 1 x 16	5	15,3 x 35	

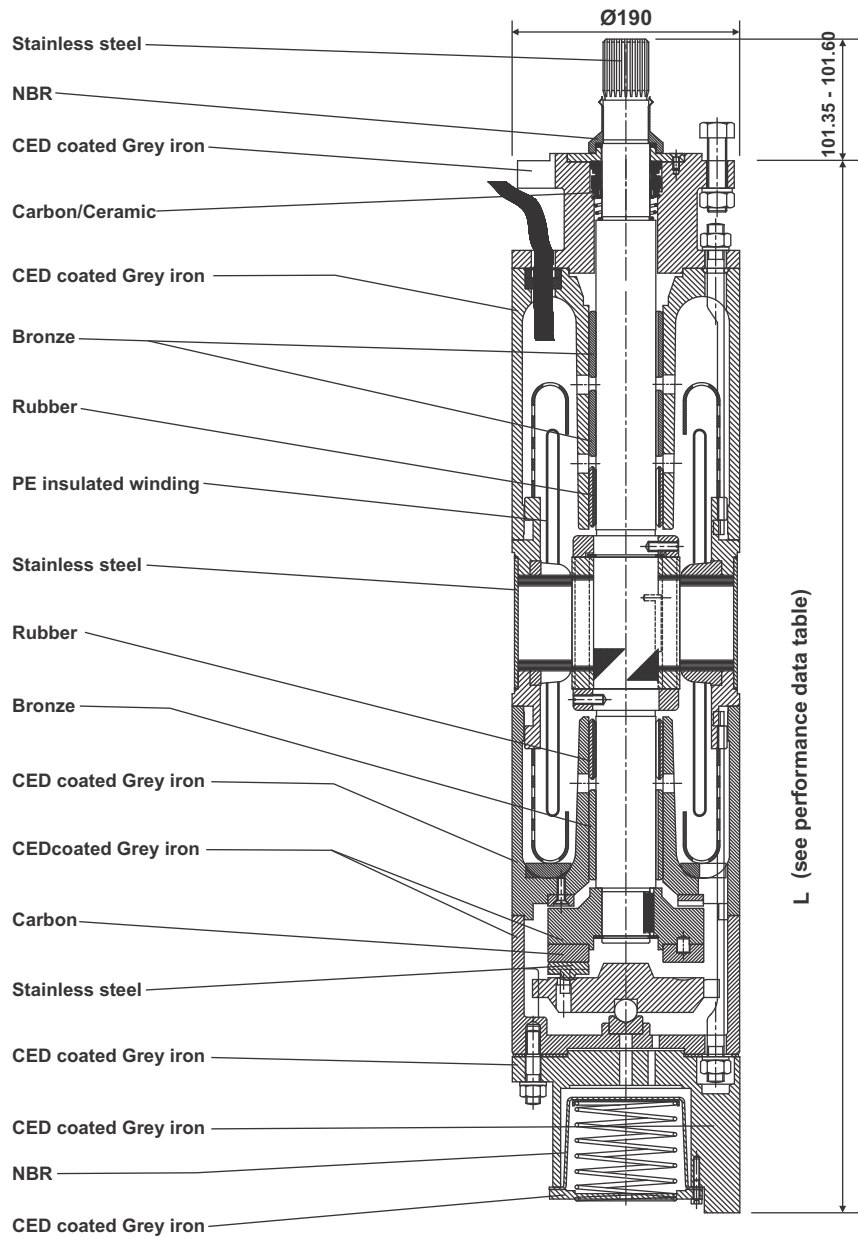
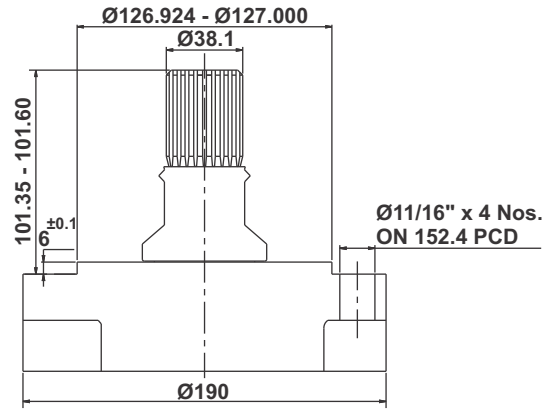

Shaft

Spline shaft: 23 teeth, 16/32 pitch, module
 1.5875, 30° pressure angle, coupling tolerance
 5 as per ANSI B.92.1, confirming with NEMA 8".



Performance data

50 Hz

Motor type	Pn		Ka [N]	Un [V]	In	Ist/In	n [min ⁻¹]	η [%]			COS φ			Tn [Nm]	L [mm]	Gross weight [kg]	Gross volume [m ³]
	kW	HP						50%	75%	100%	50%	75%	100%				
VHW82404732	30	40	45000	380	62,8	4,51	2890	79,9	83,3	84,2	0,72	0,83	0,89	99,19	1020	172,0	0,1793
				400	59,9	4,61	2900	81,1	84,1	85,0	0,71	0,84	0,89	98,84			
				415	57,8	4,66	2900	80,7	83,9	84,9	0,69	0,83	0,88	98,84			
VHW82504732	37	50	45000	380	78,0	4,70	2890	80,1	83,1	84,1	0,74	0,84	0,88	122,30	1110	194,0	0,1943
				400	75,0	4,80	2900	81,3	84,1	85,0	0,72	0,83	0,86	121,90			
				415	74,0	4,85	2900	80,7	83,5	84,4	0,70	0,80	0,84	121,90			
VHW82604732	45	60	45000	380	92,5	4,70	2890	80,3	83,3	85,2	0,73	0,87	0,88	148,80	1210	214,0	0,2130
				400	89,8	4,80	2900	81,5	84,1	85,9	0,72	0,81	0,86	148,30			
				415	88,8	4,90	2900	81,3	83,9	85,8	0,70	0,80	0,84	148,30			
VHW82754732	55	75	45000	380	113,8	4,90	2890	80,5	84,1	85,7	0,74	0,84	0,88	181,84	1260	228,0	0,2204
				400	109,5	5,00	2910	81,9	85,1	86,4	0,72	0,82	0,86	180,60			
				415	108,8	5,10	2910	81,5	84,7	86,2	0,69	0,80	0,84	180,60			
VHW82904732	66	90	45000	380	135,5	4,90	2890	80,7	85,3	86,4	0,74	0,85	0,89	218,20	1427	267,0	0,2430
				400	131,0	5,00	2910	81,9	85,9	86,9	0,72	0,83	0,86	216,70			
				415	128,5	5,05	2910	81,3	85,3	86,6	0,69	0,81	0,84	216,70			
VHW83104732	75	100	45000	380	151,0	4,91	2890	80,9	84,7	86,2	0,74	0,85	0,89	247,96	1477	278,0	0,2503
				400	147,0	5,01	2910	81,9	85,5	87,0	0,72	0,83	0,87	246,26			
				415	145,5	5,11	2910	81,7	85,3	86,6	0,70	0,79	0,84	246,26			
VHW83124732	93	125	45000	380	186,8	4,91	2900	80,5	84,5	86,5	0,75	0,84	0,88	306,40	1617	305,0	0,2690
				400	181,0	5,01	2910	81,5	86,4	87,8	0,71	0,81	0,86	305,36			
				415	180,5	5,06	2920	81,7	85,5	87,0	0,70	0,79	0,84	304,31			
VHW83154732	110	150	45000	380	231,0	4,92	2890	79,0	83,3	85,0	0,72	0,81	0,85	363,68	1747	342,0	0,2877
				400	224,0	5,02	2900	79,5	84,1	85,5	0,71	0,79	0,83	362,42			
				415	220,0	5,08	2900	80,0	84,7	86,0	0,69	0,77	0,81	362,42			
VHW83174732	130	175	45000	380	273,0	4,93	2890	79,2	83,4	85,2	0,72	0,81	0,85	429,80	1947	388,0	0,3213
				400	261,0	5,02	2900	79,7	84,3	85,7	0,71	0,80	0,84	428,32			
				415	256,0	5,08	2900	80,2	84,9	86,2	0,70	0,78	0,82	428,32			

Pn: Rated output
 Ka: Thrust load
 Un: Rated voltage
 In: Rated current
 Ist/In: Locked rotor current/Rated amperage
 n: Rated speed
 η: Efficiency
 cos φ: Power factor
 Tn: Rated torque
 L: Motor length



Features

- 8" Water filled heavy duty stainless steel submersible motor.
- Easily rewindable (wet wound) induction motor with PE insulated windings.
- Complete stainless steel AISI 304 construction.
- Mechanical shaft seal (Carbon/Ceramic) provided.
- Water lubricated heavy duty radial and axial thrust bearings.
- Counter thrust bearing.
- Motors are pre-filled with clean water + Glycol mixture.
- Shaft extension made of stainless steel AISI 316.
- High efficiency electrical design (lower operating cost).
- Tropicalized design (lower winding temperature).
- 8" NEMA coupling flange.
- Pressure compensation diaphragm.

Specifications

- Ratings: Three phase - 30 to 130 kW, 50 Hz
30 to 130 kW, 60 Hz
- Supply voltages (Tolerance +10% / -15%):
50 Hz, 3 phase, 380 V, 400 V, 415 V
60 Hz, 3 phase, 230 V, 380 V, 460 V
- Degree of protection: IP 68
- Continuous duty
- Ambient temperature: 45°C
- Rotation: Three phase - CCW and CW
- Maximum nos. of starts/hour:
30 to 55 kW - 25
66 to 130 kW - 20
- Water pH: 6,5 - 8
- Minimum cooling flow along the motor:
30 to 37 kW - 30 cm/sec
45 to 130 kW - 45 cm/sec
- Motor protection: Select thermal overload protection with trip time < 10 sec. at 5 x In
- Maximum submerged depth: 200 metres.

Special features on request

- Mechanical shaft seal Sic/Sic.
- Built-in PT 100 temperature sensor.
- Special voltages.
- Double cable for Star - Delta operation.

Cable data

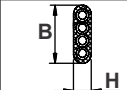
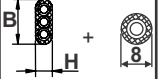
kW	Type of start	Cable x Leads x Size (mm ²)	Length [m]	H x B [mm]	
30 - 93	DOL	1 x 4 x 16	5	14 x 37,6	
110 - 130	DOL	1 x 3 x 35 + 1 x 1 x 16	5	15,3 x 35	

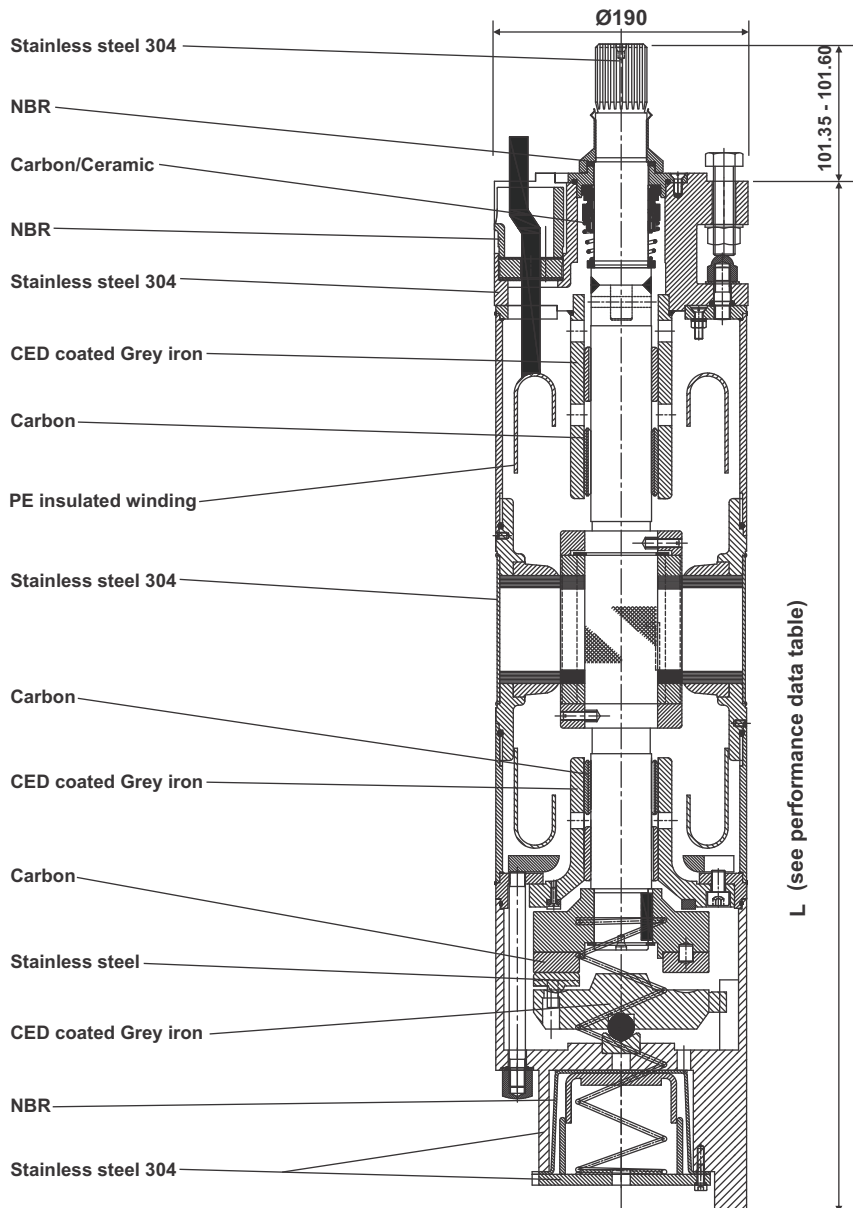
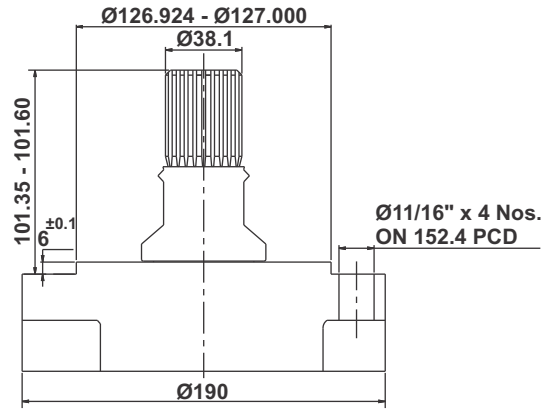

Shaft

Spline shaft: 23 teeth, 16/32 pitch, module 1.5875, 30° pressure angle, coupling tolerance 5 as per ANSI B.92.1, confirming with NEMA 8".



Performance data

50 Hz

Motor type	Pn		Ka [N]	Un [V]	In	Ist/In	n [min ⁻¹]	η [%]			COS φ			Tn [Nm]	L [mm]	Gross weight [kg]	Gross volume [m ³]
	kW	HP						50%	75%	100%	50%	75%	100%				
VXW82404732	30	40	45000	380	62,8	4,51	2890	79,9	83,3	84,2	0,72	0,83	0,89	99,19	1069	183,0	0,1900
				400	59,9	4,61	2900	81,1	84,1	85,0	0,71	0,84	0,89	98,84			
				415	57,8	4,66	2900	80,7	83,9	84,9	0,69	0,83	0,88	98,84			
VXW82504732	37	50	45000	380	78,0	4,70	2890	80,1	83,1	84,1	0,74	0,84	0,88	122,30	1159	205,0	0,2100
				400	75,0	4,80	2900	81,3	84,1	85,0	0,72	0,83	0,86	121,90			
				415	74,0	4,85	2900	80,7	83,5	84,4	0,70	0,80	0,84	121,90			
VXW82604732	45	60	45000	380	92,5	4,70	2890	80,3	83,3	85,2	0,73	0,87	0,88	148,80	1259	228,0	0,2200
				400	89,8	4,80	2900	81,5	84,1	85,9	0,72	0,81	0,86	148,30			
				415	88,8	4,90	2900	81,3	83,9	85,8	0,70	0,80	0,84	148,30			
VXW82754732	55	75	45000	380	113,8	4,90	2890	80,5	84,1	85,7	0,74	0,84	0,88	181,84	1309	240,0	0,2300
				400	109,5	5,00	2910	81,9	85,1	86,4	0,72	0,82	0,86	180,60			
				415	108,8	5,10	2910	81,5	84,7	86,2	0,69	0,80	0,84	180,60			
VXW82904732	66	90	45000	380	135,5	4,90	2890	80,7	85,3	86,4	0,74	0,85	0,89	218,20	1398	249,0	0,2400
				400	131,0	5,00	2910	81,9	85,9	86,9	0,72	0,83	0,86	216,70			
				415	128,5	5,05	2910	81,3	85,3	86,6	0,69	0,81	0,84	216,70			
VXW83104732	75	100	45000	380	151,0	4,91	2890	80,9	84,7	86,2	0,74	0,85	0,89	247,96	1448	261,0	0,2500
				400	147,0	5,01	2910	81,9	85,5	87,0	0,72	0,83	0,87	246,26			
				415	145,5	5,11	2910	81,7	85,3	86,6	0,70	0,79	0,84	246,26			
VXW83124732	93	125	45000	380	186,8	4,91	2900	80,5	84,5	86,5	0,75	0,84	0,88	306,40	1588	293,0	0,2700
				400	181,0	5,01	2910	81,5	86,4	87,8	0,71	0,81	0,86	305,36			
				415	180,5	5,06	2920	81,7	85,5	87,0	0,70	0,79	0,84	304,31			
VXW83154732	110	150	45000	380	231,0	4,92	2890	79,0	83,3	85,0	0,72	0,81	0,85	363,68	1718	323,0	0,2900
				400	224,0	5,02	2900	79,5	84,1	85,5	0,71	0,79	0,83	362,42			
				415	220,0	5,08	2900	80,0	84,7	86,0	0,69	0,77	0,81	362,42			
VXW83174732	130	175	45000	380	273,0	4,93	2890	79,2	83,4	85,2	0,72	0,81	0,85	429,80	1918	370,0	0,3200
				400	261,0	5,02	2900	79,7	84,3	85,7	0,71	0,80	0,84	428,32			
				415	256,0	5,08	2900	80,2	84,9	86,2	0,70	0,78	0,82	428,32			

Pn: Rated output
 Ka: Thrust load
 Un: Rated voltage
 In: Rated current
 Ist/In: Locked rotor current/Rated amperage
 n: Rated speed
 η: Efficiency
 cos φ: Power factor
 Tn: Rated torque
 L: Motor length

